

**DU-CO CERAMICS COMPANY**  
 P.O. Box 568 Saxonburg, Pennsylvania 16056

Phone: 724-352-1511  
 FAX: 724-352-1266  
 Web: www.du-co.com  
 E-mail: sales@du-co.com

## Ball & Socket Beads

Part No.	OD	ID	Length	PCS/FT.	PCS/LB.
A-258	.110	.056	.110	134	19,740
A-259	.125	.056	.125	110	11,820
A-260	.170	.068	.170	86	4,450
A-261	.200	.092	.200	70	2,967
A-262	.200	.098	.200	70	2,900
A-264	.260	.116	.260	54	1,375
A-265	.260	.156	.260	54	1,549
A-1330	.260	.130	.320	44	1,400
A-266	.330	.124	.330	42	588
A-385	.375	.250	.375	38	400
A-267	.400	.156	.400	34	360
A-268	.400	.180	.400	34	378
A-269	.440	.180	.440	34	263
A-519	.440	.250	.440	34	280
A-408	.500	.218	.500	29	173
A-270	.540	.200	.540	27	154
A-304	.540	.355	.540	27	165
A-682	.875	.500	.875	13	100

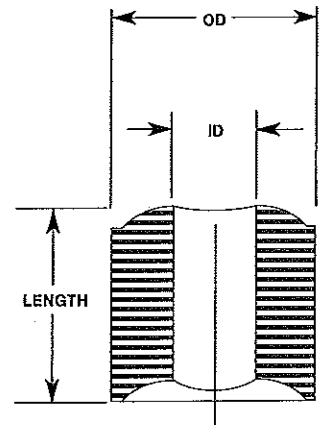

Ball & Socket beads are concave on one end and convex on the other.  
 When beads are strung convex to concave on the wire, the wire can flex or bend and still maintain the ceramic insulated conductor.

These items are standard tooling. Please call for quotation on your quantity and delivery information.